

# Instructions for SOTA Silver Pulser Model SP5 with Silver Probes



## CONTENTS

INTRODUCTION .....	2
LEARN MORE .....	2
COMPLEMENTARY UNITS.....	2
COMPLETE UNIT INCLUDES.....	2
DO NOT USE.....	3
MICROPULSING CAUTIONS .....	3
Sensitive Skin .....	4
IONIC~COLLOIDAL SILVER CAUTIONS.....	5
SUMMARY OF LIGHTS .....	5
HOW TO USE THE MICROPULSING FUNCTION .....	5
How Micropulsing Should Feel .....	8
Typical Use .....	8
HOW TO USE THE IONIC~COLLOIDAL SILVER FUNCTION .....	9
How to Assemble .....	9
How to Make Ionic~Colloidal Silver.....	9
Typical Use.....	11
ELECTRICAL SPECIFICATIONS .....	11
Power Requirements.....	11
Optional Power Input.....	12
Output Specifications.....	12
TROUBLESHOOTING.....	12
COUNTRIES THAT PARTICIPATE IN MANUFACTURING .....	13
REPLACEMENT ACCESSORIES .....	13
WARRANTY.....	13
REPAIRS.....	13





## INTRODUCTION

Thank you for allowing us to be a part of your wellness team. The Silver Pulser is a consumer product designed to complement a healthy lifestyle.

This unit has two functions:

1. Micropulsing to apply gentle microcurrents.
2. Making Ionic~Colloidal Silver.

Please understand that results will vary. Healthy lifestyle choices are important.

Please read this manual carefully before using the Silver Pulser. The information in this manual is subject to change. For the most up-to-date manual, please visit [www.sota.com](http://www.sota.com). We encourage you to become well-informed about Micropulsing and the use of Ionic~Colloidal Silver.

The SOTA Silver Pulser is built to give you many years of trouble-free use.

## LEARN MORE

To learn more about the Silver Pulser we invite you to visit the SOTA website:

**[www.sota.com](http://www.sota.com)**

The website offers How to Videos, Frequently Asked Questions, a Guide to Using the SOTA Units, SOTA News ... and more.



## COMPLEMENTARY UNITS

The Silver Pulser offers two parts of the 4-part SOTA Protocol:

1. The Silver Pulser for Micropulsing.
2. The Magnetic Pulser for Pulsed Magnetic Fields.
3. The Silver Pulser for making Ionic~Colloidal Silver.
4. The Water Ozonator for freshly Ozonated Water.

## COMPLETE UNIT INCLUDES

- One (1) Silver Pulser Unit
- One (1) 9-Volt Alkaline Battery
- One (1) Carrying Case
- One (1) Product Manual



## **FOR MICROPULSING APPLICATION:**

- One (1) Micropulsing Cord
- Six (6) Pair Cotton Sleeves
- One (1) Arm Band with Clip
- One (1) Neoprene® Velcro® Wrist Strap
- One (1) 50 ml Dark Glass Dropper Bottle

## **FOR MAKING IONIC~COLLOIDAL SILVER:**

- One (1) Silver Wire Holder
- Two (2) Silver Wires of .9999 (4 Nine) Purity
- One (1) Green Scrub Pad

## **DO NOT USE**

1. Do not use the Micropulsing function in the following situations as safety has not been explored:
  - a. In the case of pregnancy, nursing or trying to get pregnant.
  - b. With an implanted device such as a pacemaker, shunt etc.
  - c. If taking a pharmaceutical drug or any recreational drugs.
  - d. With Neuropathy or other nerve-ending related issues.
2. Do not take Ionic~Colloidal Silver in the following situations as safety has not been explored:
  - a. In the case of pregnancy, nursing or trying to get pregnant.
3. As with all electrical products do not use:
  - a. Near water
  - b. When driving a car
  - c. When operating heavy equipment

## **MICROPULSING CAUTIONS**

1. Do not place the Micropulsing probes over skin lesions, abrasions, new scars, cuts, eruptions or sunburn.
2. Do not use if the Micropulsing suddenly feels different or prickly and the YELLOW light stops flashing. Turn the unit off immediately and contact SOTA.





3. Microcurrents may increase the absorption of nutrients and drugs. As a precaution do not use with substances that are potentially harmful - recreational drugs, prescription drugs, nicotine products, alcohol, coffee etc.
4. Do not apply the bare metal pins to the skin.
5. Keep the cotton sleeves damp. Both dry sleeves and bare metal pins will cause an electrical burn which may scar.
6. Do not sleep while Micropulsing as the sleeves may dry out. This could result in an electrical burn.
7. During the first weeks of use, the skin may become irritated. Over time, irritation usually decreases or disappears. Alternating wrists each session allows any irritation to better heal.

### **SENSITIVE SKIN**

Some individuals may be particularly sensitive to microcurrents and the irritation may continue. To minimize irritation:

- a. Wash wrists thoroughly after each session and apply a healing gel or lotion such as aloe vera, vitamin E or MSM cream.
- b. Micropulse for shorter periods of time until the irritation disappears.
- c. Alternate wrists daily.
- d. Wet the cotton sleeves with distilled water or Ionic~Colloidal Silver. The silver solution has a healing effect. If unable to feel the current, try a commercial saline solution for the eyes. This is gentler than adding salt to the water.
- e. A conductive gel or aloe vera gel added to the wet sleeves may help to reduce irritation.
- f. Another option is to wrap a small square of paper towel around the probes instead of using cotton sleeves. Keep the paper well moistened. A small square of paper towel may last for several applications. If available, use unbleached paper towel.
- g. Set the intensity dial to a comfortable level. The yellow flashing light needs to be visible indicating the current is flowing.



## IONIC~COLLOIDAL SILVER CAUTIONS

1. We recommend taking occasional breaks from consuming Ionic~Colloidal Silver for the following two reasons:
  - a. Growth of healthy bacteria in the gut may be slowed. It may be wise to supplement with a probiotic (friendly bacteria) to replenish the gut from time to time.
  - b. Ingesting large quantities of Ionic~Colloidal Silver over a long period of time could possibly result in argyria. Argyria is a darkening of the skin – a bluish tinge. This occurs when silver molecules are eliminated through the skin and exposed to light. Darkening of the moons of the finger nails is usually an early sign of argyria. The bluish tinge becomes especially noticeable around the eyes and nose on the face.

The risk of argyria is considered greater with larger particle sizes. When made with a constant current unit using distilled water, the particle size remains small so the risk of argyria is considered less.

The risk of argyria is greater if one is deficient in selenium or vitamin E. Drinking Ionic~Colloidal Silver for long periods of time is known to deplete selenium and vitamin E. In addition to taking breaks from ingesting Ionic~Colloidal Silver, it may be wise to supplement with these two nutrients.

## SUMMARY OF LIGHTS

GREEN: Indicates the unit is on.

RED: Indicates the battery is low and will soon need replacing.

YELLOW: Indicates the Micropulsing function is in operation.

ORANGE: Indicates the Ionic~Colloidal Silver function is in operation.

## HOW TO USE THE MICROPULSING FUNCTION

1. Place the 9-Volt Alkaline battery in the unit.
  - a. On the back of the unit, slide off the battery cover.

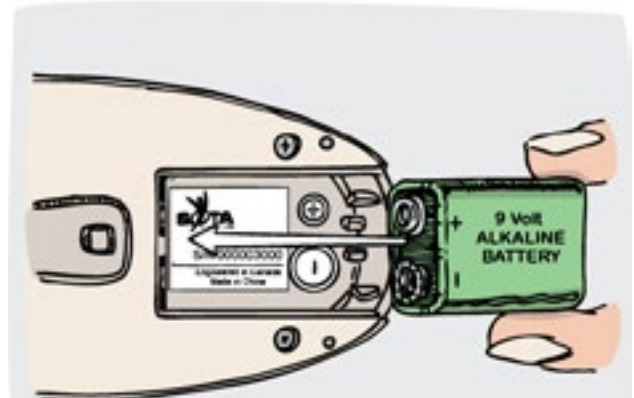



b. Position the 9-Volt Alkaline battery so the positive (+) and negative (-) terminals line up as in image 1 on page 5.

Note: The smaller circle on the battery matches the smaller circle in the case ... the larger battery circle matches the larger circle in the case.

c. Slide the 9-Volt Alkaline battery into the case and push down. Slide the cover back onto the unit.

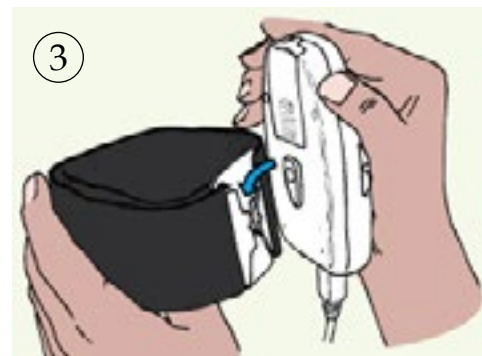

2. Clean the wrist area to remove oils from the skin. This will allow for better conductivity.

3. Insert the Micropulsing Cord into the jack on the unit as shown in image 2. The indented square on the DIN plug should be facing up. When the plug is positioned correctly, it will slide in gently. Do not force.

4. Slide the clip on the back of the Silver Pulser into the holding clip on the Arm Band as in image 3.

5. Slide the Arm Band, with the unit and cord, up the arm to a comfortable position. Tighten the band to secure it in place as in image 4.



Option: If preferred the unit can be placed in a pocket.

A longer Micropulsing Cord is needed for this option.

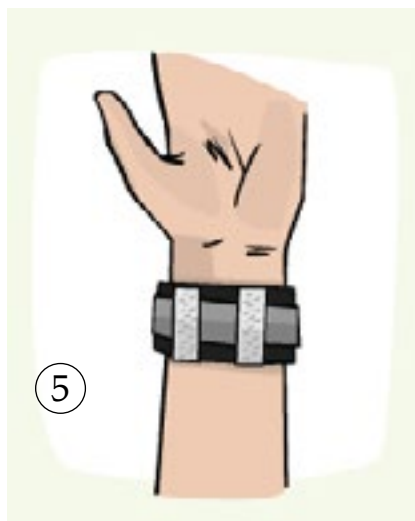

6. To position the cotton sleeves on the wrist strap, place the Velcro side of the wrist band face-out rather than towards the skin.

Attach one cotton sleeve to the wrist band in line with the pulse point on the thumb side of the wrist. Press the sleeve to the wrist band to firmly adhere the sleeve in place.

Place the other cotton sleeve in line with the pulse point on the little finger side of the wrist. This pulse point is usually harder to feel. It is located in the soft hollow on



the wrist, in line with the little finger. Press the sleeve to the wrist strap to firmly adhere the sleeve in place. See image 5.

Once in place, the cotton sleeves will stay in the right position for repeated use.

7. Take the wrist strap off.

8. Insert one probe from the Micropulsing Cord into each of the cotton sleeves. Use a gentle twisting motion to work the probes into the cotton sleeves.

9. Wet the cotton sleeves with water.

10. Put the wrist strap on so the damp cotton sleeves are against the skin over the pulse points. See image 6.

11. Turn the unit ON by rotating the ON/OFF switch clockwise.

Turn the switch slowly until you feel the current. If you do not feel the current, see Notes below.

a. The GREEN light indicates the unit is ON. If the light does not come on, the battery may not be placed correctly.

b. The flashing YELLOW light should come on and get brighter as the intensity is turned up. If the flashing YELLOW light does not come on, the electrical path has not been established. See Troubleshooting on page 12.

13. When finished, turn the unit OFF by rotating the ON/OFF switch counter clockwise until it clicks. Do not force the ON/OFF switch past its natural stopping point.

14. Unplug the Micropulsing Cord. Do not store the unit with the Micropulsing Cord plugged in as this can damage the Cord.

15. The cotton sleeves will remain correctly positioned for the next session.

16. Clean the wrist and apply a healing lotion to avoid irritation.





## Notes:

**Suggestions for Feeling the Current:** If the current is not felt with wet cotton sleeves, prepare a mild salt solution to wet the sleeves. Add only a few grains of salt to the water in the 50 ml dropper bottle. Alternatively, a conductive gel or aloe vera gel may be used instead of a salt solution. Drink enough water to keep the body well hydrated. The level of hydration may affect sensitivity.

**Care of Micropulsing Cord:** Discoloration of probes is normal. Buff occasionally to remove stains to ensure good electrical contact.

**Care of Cotton Sleeves:** Wash or rinse sleeves occasionally. Discard and replace cotton sleeves periodically.

**Alternatives to Cotton Sleeves:** The following items can be used in place of the cotton sleeves with velcro:

- a. All Cotton Sleeves: SOTA also offers cotton sleeves without velcro.
- b. Unbleached Paper Towel: Cut a small square of paper towel large enough to wrap around the probe 2 or 3 times. Moisten prior to use.
- c. Cotton Flannel: Cut a small square of cotton flannel and wrap around the probe with thread. Moisten prior to use.

**Low Battery Warning:** The RED light comes on when the battery is low. This means the battery will soon need to be replaced. The battery can continue to be used until the YELLOW light goes off.

**Power Supply:** When Micropulsing, the unit can only be powered by a 9-Volt Alkaline battery.

**Replacement Batteries:** When purchasing replacement 9-Volt batteries, take the Silver Pulser with you to ensure a proper fit, as 9-Volt batteries vary in size.

## HOW MICROPULSING SHOULD FEEL

1. The sensation is a gentle pulsing. While the microcurrents should be felt, it is not necessary to turn the intensity control up to an uncomfortable level.
2. With repeated use, the ability to feel the microcurrents may change. It may be necessary to increase the intensity in order to feel the microcurrents.
3. Twitching of the fingers is normal at a higher intensity.

## TYPICAL USE

Alternate wrists daily.





**Length of Session:** Build up time gradually. It is best to start slowly. Start with 10 to 20 minutes a day. Increase gradually to a minimum of 2 hours each day.

**Length of Use:** After daily use for 6 to 12 weeks, a maintenance schedule is important. See below for suggestions.

**Drink plenty of water:** It's important to drink enough water when using the unit. Drinking ozonated water is especially helpful.

**Stop Gradually:** Reduce the amount of time each day for the last week of use. If using the 4-part SOTA Protocol, it is suggested to stop only one part of the protocol at a time.

**Maintenance Schedule:** Ongoing use may be beneficial. Suggestions for a maintenance schedule are a) once weekly, b) one week per month, or c) 4 weeks every six months.

## HOW TO USE THE IONIC~COLLOIDAL SILVER FUNCTION

### HOW TO ASSEMBLE

1. The Silver Wires fit into the two small holes in the Silver Wire Holder.
2. To insert the Silver Wires, move the spring clip away from the hole to allow the wire to slide in smoothly.
3. Insert as in the picture. Push the wire through. Most of the wire should be below the holder. It may be easier to insert from the underside of the holder.
4. Release the clip to hold the Silver Wire snugly in place.
5. Repeat the above steps for the second Silver Wire and plug the Silver Wire Holder into the Silver Pulser, ensuring that the flat side of the plug is facing up.

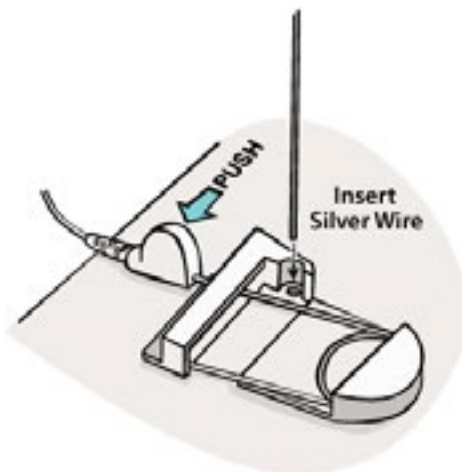

### HOW TO MAKE IONIC~COLLOIDAL SILVER

The Silver Pulser provides a constant current output, which allows for a very simple procedure for making a high quality Ionic~Colloidal Silver as room temperature water can be used.

1. Pour two cups (16 ounces or 500 ml) of room temperature distilled water into a tall glass or jar. Do not use a metal or plastic container.



2. Place the Silver Wire Holder on the glass or jar immersing the Silver Wires. Keep them at least 25 mm or 1 inch from the bottom of the container.
3. Turn the unit ON by rotating the ON/OFF switch clockwise until it clicks. It is not necessary to turn up the intensity.

The ORANGE light will brighten as the current increases up to the 1.0 mA limit.

4. Stir occasionally with a non-metal utensil. Occasionally, wipe off the grey or black silver oxide that builds up on the Silver Wires.
5. Two cups (16 ounces or 500 ml) for 2 hours will produce a 5 to 8 PPM batch of Ionic~Colloidal Silver, depending on the brand of distilled water. The concentration of silver is measured in Parts Per Million or PPM.



Note: With constant current the time required to produce 5 PPM or more will not be reduced by adding salt or by heating the water. The current is held steady and is not influenced by salt or heat.

6. When finished, wipe the Silver Wires with paper towel to remove residue. Buff lightly when needed to keep them free of sediment. Harsher buffing will wear away the silver faster.

#### Notes:

**Color:** Ionic~Colloidal Silver remains colorless to about 5 or 6 PPM. At a slightly higher PPM it will be a pale gold color. Do not drink if it is darker than pale gold as this indicates a higher level of impurities or larger particle sizes.

**Clarity:** The solution should be clear. Do not drink if it is cloudy.

**To Make Larger Quantities:** The Silver Pulser can be used to make larger quantities of Ionic~Colloidal Silver. For a concentration between 5 to 8 PPM, use the following times as a guide:

For 4 cups or 1 litre: 3 to 4 hours.

For 1 gallon (16 cups) or 4 liters: 10 to 12 hours.

**Storage:** Pour the Ionic~Colloidal Silver into a dark glass bottle – never metal – and store in a dark, dry place. Over time, light will degrade Ionic~Colloidal Silver



by turning the solution grey or black.

When made and stored properly, Ionic~Colloidal Silver retains freshness for many weeks. It is suggested, however, that you use as soon as possible. If settling occurs, it is losing potency. Do not drink any sediment.

Do not freeze, refrigerate, or expose Ionic~Colloidal Silver to extremes of temperatures as its potency may be affected.

**Save on batteries:** The unit can be powered by an AC-DC wall adaptor when making Ionic~Colloidal Silver. See page 11 for specifications.

**Switch Silver Wire positions:** The silver ions only come off the wire in the positive (+) or anode terminal into the water. To equalize the wearing of the Silver Wires, exchange the position of the wires after each use. If left in the same position, only one Silver Wire will gradually wear away.

**Replacing the Silver Wires:** The Silver Wires are of the highest grade .9999 or 99.99% or 4 Nine pure fine silver. When the SOTA pure Silver Wires wear too thin, do not replace with sterling silver, as it contains nickel, which can be toxic.

## TYPICAL USE

**Quantity:** There is no definite amount to drink. When consumed on a regular basis – daily or several times a week – it is best to drink no more than 1 to 2 ounces (30 to 60 ml) at a time.

**Length of Use:** One to 2 ounces or more daily for 2 or 3 months.

**Strength:** Laboratory testing indicates Ionic~Colloidal Silver is effective as low as 2 PPM. When ingesting on a regular basis, it is suggested to limit the strength to less than 10 PPM.

**Maintenance Schedule:** After the initial program, suggestions for maintenance are a) use daily 3 or 4 days per week, b) use daily for 2 weeks each month, or c) use daily for three months per year. After an extended period of use, it is wise to take breaks.

## ELECTRICAL SPECIFICATIONS

### POWER REQUIREMENTS

Use a 9-Volt Alkaline battery for proper operation.



## OPTIONAL POWER INPUT

Both functions of the Silver Pulser can also be operated using NiMH rechargeable batteries. When purchasing rechargeable batteries, it is suggested to take the unit with you to ensure the batteries will fit the enclosure.

To use a wall adaptor for making Ionic~Colloidal Silver the output should be from 6 to 12 Volts DC with a **Tip or Center Positive** pin and a minimum of 500 mA (milliamperes) of current. The wall adaptor that comes with other SOTA units can be used for making Ionic~Colloidal Silver.

**Caution:** Exceeding the voltage rating or reverse connection may result in injury or unit failure. This will **void** the warranty.

To operate the Ionic~Colloidal Silver Function from a 12 Volt DC source, such as an automobile battery or an appropriate Solar Panel, purchase a Universal Power Cord with **POSITIVE** tip.

## OUTPUT SPECIFICATIONS

The output voltage is a nominal 31 Volts.

**Micropulsing Application:** Frequency through probes is ~3.92 Hz or 1/2 of the Earth Schumann frequency of 7.83 Hz, (+/- 1 Hz) with a Bi-Phasic Square Wave @ 31 Volts (+/- 1 Volt) peak per cycle.

Maximum current through the probes is ~8 milliamperes into 1,000 ohms, ~12 milliamperes into a short circuit at 31 Volts peak per cycle.

**Ionic~Colloidal Silver Application:** The maximum current through the Silver Wires is 1.0 milliamperes (+/- 0.5 mA) at 31 VDC compliance voltage when the Silver Wires are touched together to short the circuit.

## TROUBLESHOOTING

If the **YELLOW** light does not come on and the microcurrents cannot be felt, replace the 9-Volt Alkaline battery.

If the problem persists:

Plug the Micropulsing Cord into the unit. Turn the unit ON and touch the metal pins together. The **YELLOW** light should come on and flash. Turn up the intensity and the flashing **YELLOW** light should get brighter. If the light does not come on, the Micropulsing Cord may need replacing.

For further Troubleshooting, visit [www.sota.com](http://www.sota.com).



## COUNTRIES THAT PARTICIPATE IN MANUFACTURING

The manufacturing of the SOTA Products is a global collaboration. The following countries have participated in the making of the Silver Pulser (listed in alphabetical order): **Canada, China, Hong Kong, Malaysia, Mexico, South Korea, Taiwan** and the **USA**.

## REPLACEMENT ACCESSORIES

To replace your accessories, please contact your supplier.

## WARRANTY

The Silver Pulser, SP5 is covered by a three (3) year limited warranty. Please keep proof of purchase. Warranty is void if the failure is due to abuse or negligence. SOTA reserves the right to make changes to the Silver Pulser without notification.

## REPAIRS

Please contact your supplier for return instructions. Or, for information about your closest repair depot, contact:

repairs@sota.com  
Tel: 1.250.770.2023  
Fax: 1.250.770.1999



Made in China and Designed and Engineered in Canada.

• The SOTA units are consumer products designed for relaxation, well-being and to complement a healthy lifestyle • The SOTA units are not medical devices nor are they intended to diagnose, treat or cure any medical or health condition • The use, safety or effectiveness of the SOTA units, has not been approved by any government agency • Please consult a health practitioner for any medical or health condition. • Results using the SOTA Products will vary for each person. • Please note that all purchases of SOTA Products are deemed to be made in Penticton, BC, Canada •

